



Holy Enterprise Limited

FL.2, No.12 North Ave.1, Industrial Rd. East, Gusan, Guzhen, Zhongshan, Guangdong, China

Specification

6FM-26DC 12V26AH/20HR

Cells Per Unit	6
Voltage Per Unit	12
Capacity	26AH@20hr-rate to 1.8V per cell @ 25°C
Weight	Approx.8.4kg (Tolerance±3%)
Max. Discharge Current	260 A(5sec)
Internal Resistance	Approx 14 mΩ
Operating Temperature	Discharge: -20°C~50°C Charge: 0°C~40°C Storage: -20°C~50°C
Normal Operating Temperature	25±3°C
Float Charging Voltage	2.25 to 2.27 VDC/unit Average at 25°C
Maximum Charging Current	7.8 A
Equalization and Cycle service	2.35 to 2.40 VDC /unit Average at 25°C
Terminal	Terminal: NB/B



Application

Uninterruptible Power System;
Communication Equipments;
Solar Power Systems;
Solar Power Street Light;
Wind Power Systems

Dimension: 165(L) ×175(W) ×126(H) (Total 126 mm)

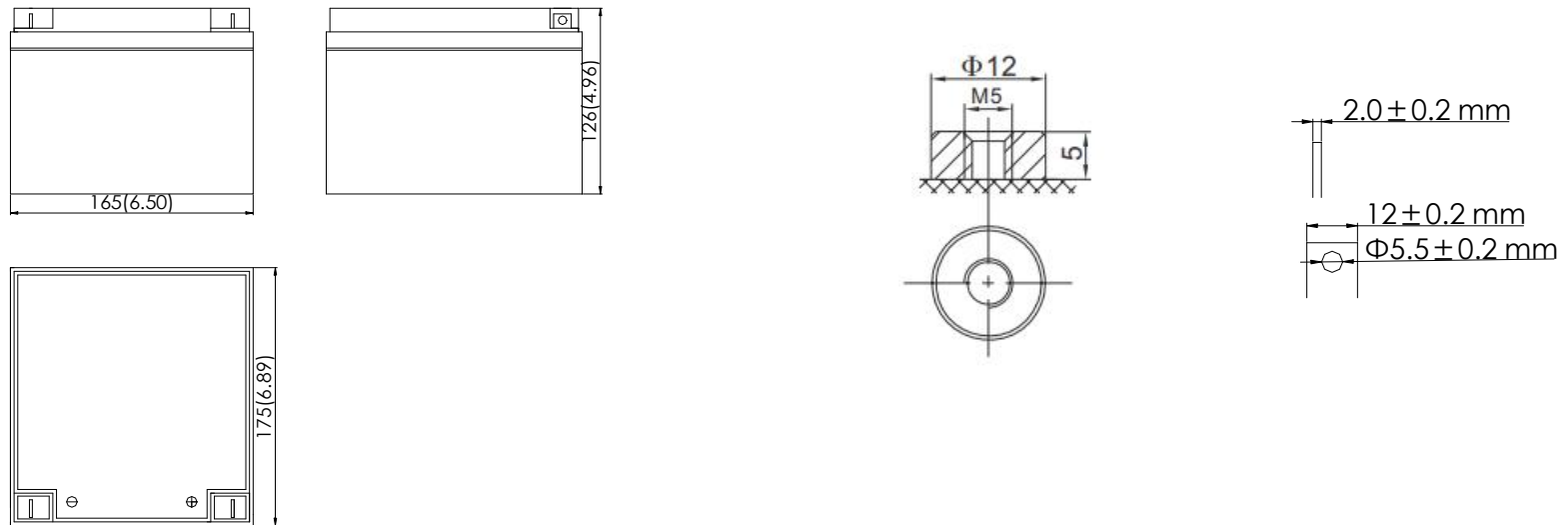

Constant Current Discharge Characteristics: A(25°C)

F.V/Time	5MIN	10MIN	15MIN	30MIN	60MIN	2HR	3HR	4HR	5HR	8HR	10HR	20HR
1.80V/cell	61.86	47.74	36.84	23.05	13.06	8.50	6.50	5.30	4.42	2.979	2.430	1.287
1.75V/cell	70.45	52.74	39.90	24.12	13.58	8.81	6.71	5.46	4.54	3.031	2.461	1.300
1.70V/cell	78.63	57.62	42.87	25.23	14.10	9.13	6.91	5.60	4.65	3.073	2.494	1.316
1.65V/cell	87.15	62.59	45.77	26.40	14.57	9.44	7.11	5.76	4.78	3.121	2.532	1.332
1.60V/cell	93.72	66.23	47.88	27.50	15.09	9.75	7.33	5.92	4.91	3.157	2.564	1.354

Constant Power Discharge Characteristics: W/Unit(25°C)

F.V/Time	5MIN	10MIN	15MIN	30MIN	60MIN	2HR	3HR	4HR	5HR	8HR	10HR	20HR
1.80V/cell	664.8	523.5	409.5	261.7	150.84	98.58	75.72	61.98	51.84	35.21	28.81	15.28
1.75V/cell	741.0	568.4	437.3	271.0	155.94	101.70	77.82	63.60	53.02	35.74	29.15	15.42
1.70V/cell	809.4	610.2	463.2	280.7	160.86	104.94	79.92	65.04	54.20	36.17	29.50	15.59
1.65V/cell	876.6	650.4	487.3	290.7	165.24	107.88	81.78	66.60	55.46	36.65	29.91	15.76
1.60V/cell	932.4	675.6	502.2	299.7	170.16	110.94	84.00	68.16	56.72	36.99	30.23	15.99

All mentioned values are average values.

Discharge Characteristics Curve

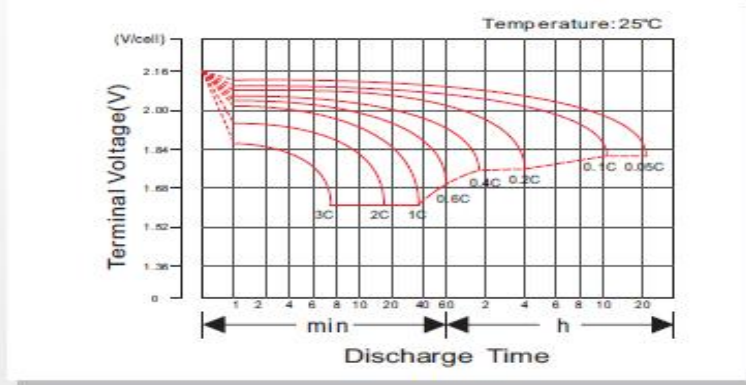

Charging Characteristics Curve

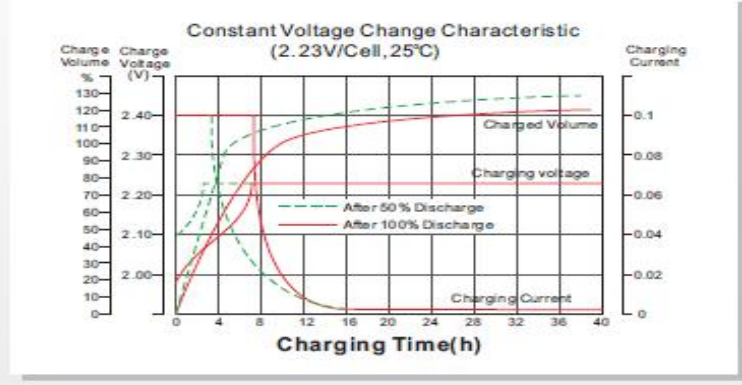

Cycle life in relation to depth of Discharge

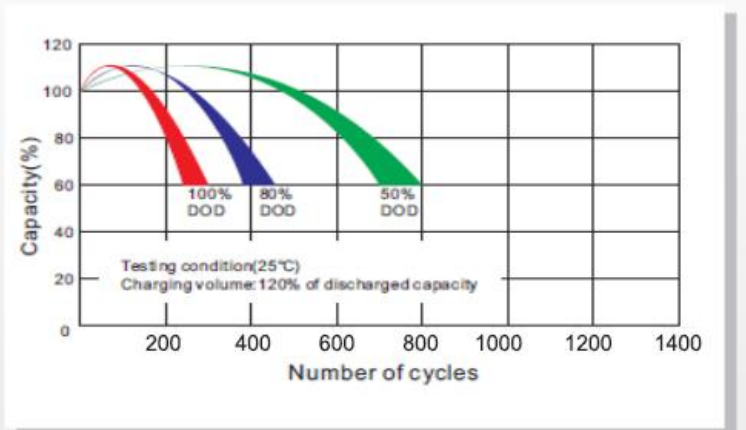

Temperature effects on Capacity

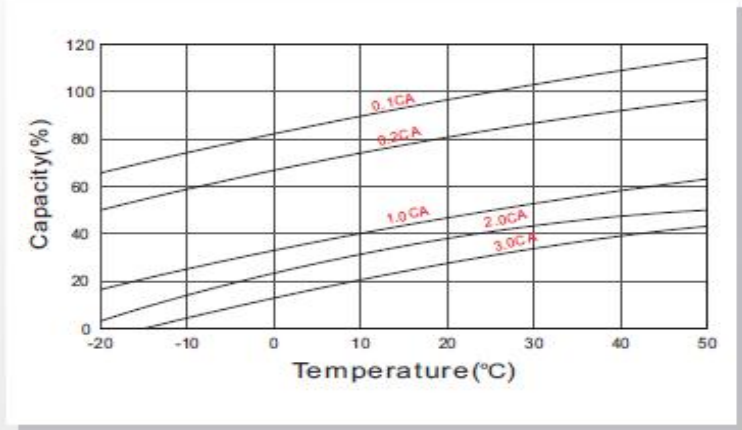

Relationship between charging voltage and temperature

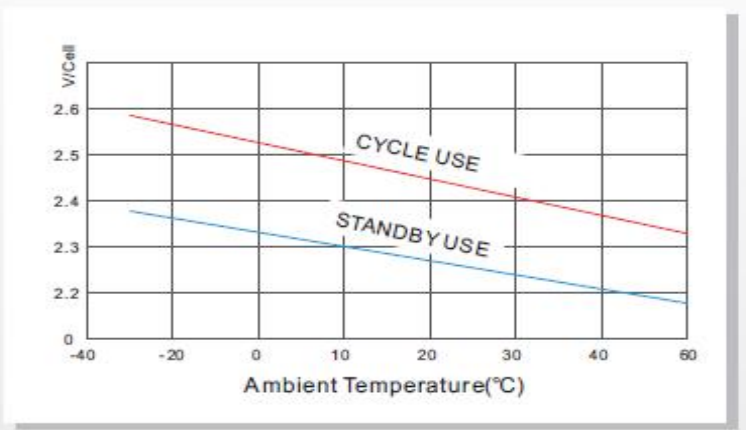

Self-discharge Characteristics

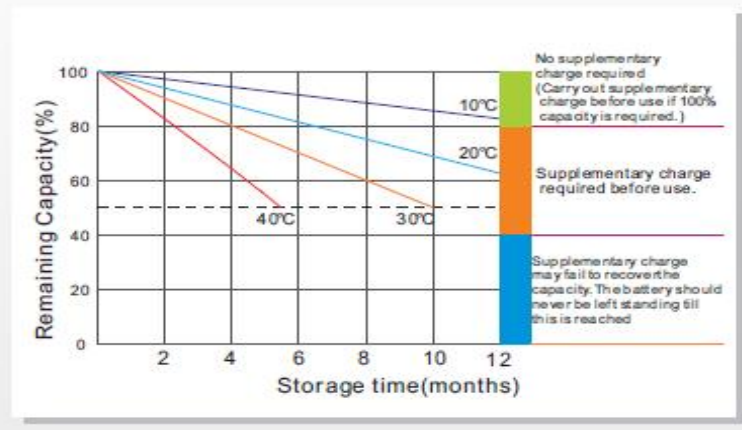

Temperature effects on Float life

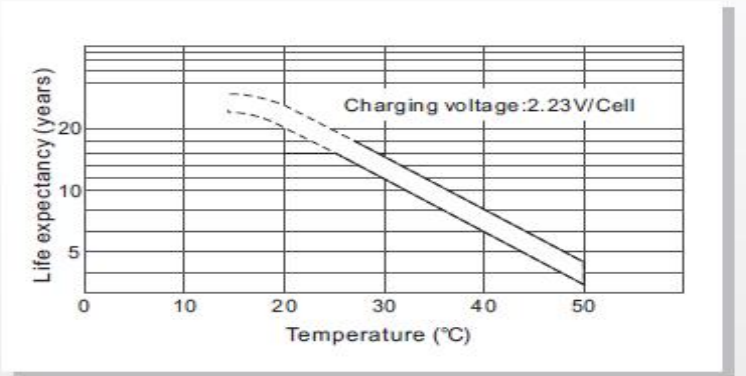

Life Characteristics of Standby use

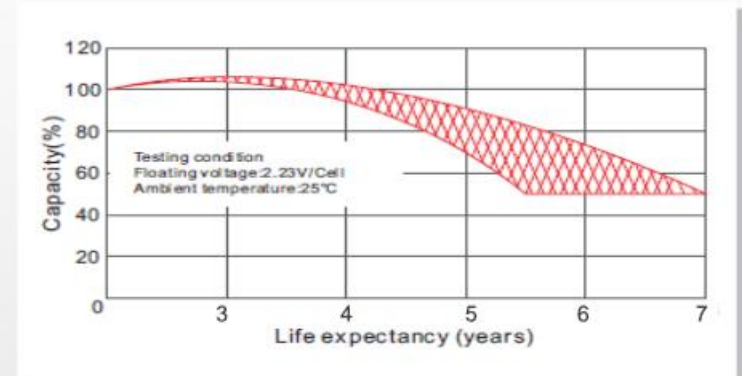

Maintenance & Cautions

- ※ Every month, recommend inspection every battery voltage;
- ※ Every three months, recommend equalization charge once;
Equalization charge method:
Discharge: 100% rate capacity discharge;
Charge: Max. Current 0.3CA, constant voltage 2.35-2.4V/Cell;
- ※ Effect of temperature on float charge voltage: -3mV/Cell;

CONTACT Us

Add: FL.2, No.12 North Ave.1, Industrial Rd. East, Gusan, Guzhen, Zhongshan, Guangdong, China,
T: +86-760- 8862 5562 | **F:** +86-760-8862 5562
Email: sales@holybattery.com johny5@126.com
Website: www.holybattery.com