



Holy Enterprise Limited

FL.2, No.12 North Ave.1, Industrial Rd. East, Gusan, Guzhen, Zhongshan, Guangdong, China

Specification

EV 6-DZM-33-12V33AH/2HR

Cells Per Unit	6
Voltage Per Unit	12
Capacity	33AH@2hr-rate to 1.75V per cell @ 25°C
Weight	Approx.: 11.30kg (Tolerance±3%)
Max. Discharge Current	330A(5sec)
Internal Resistance	Approx 12.0mΩ
Operating Temperature Range	Discharge: -20°C~50°C Charge: 0°C~40°C Storage: -20°C~50°C
Normal Operating Temperature	25±3°C
Float Charging Voltage	13.6 to 13.8 VDC/unit Average at 25°C
Maximum Charging Current	8.6A
Equalization and Cycle service	14.5 to 14.9 VDC /unit Average at 25°C
Terminal	Terminal: M5/M6



Application

- Electric golf carts
- Electric wheelchairs
- Cleaning machines
- Electric Vehicles
- Power Tools
- Mowers

Dimension: 195(L) ×130(W) ×155(H) (Total 168 mm)

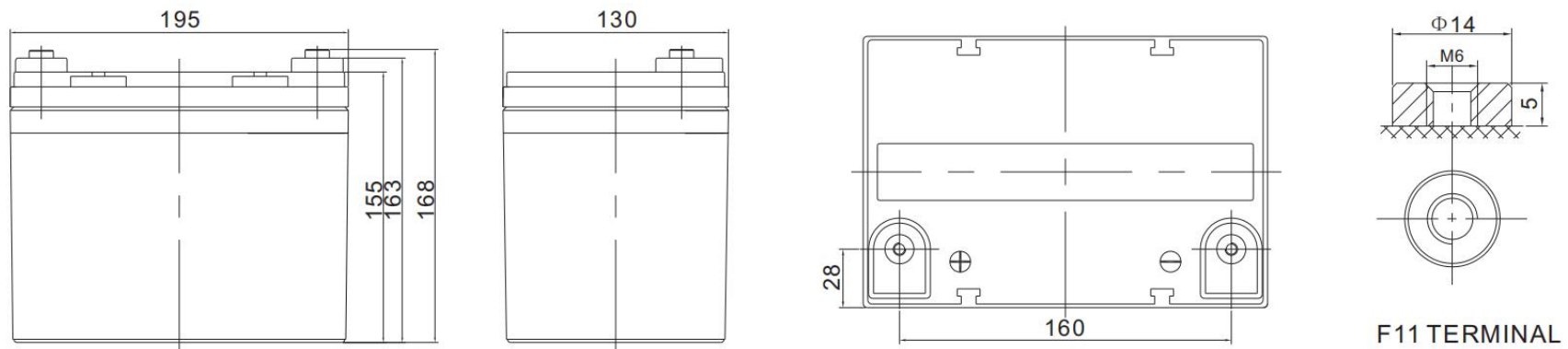

F11 TERMINAL

Constant Current Discharge Characteristics: A(25°C)

F.V/Time	5MIN	10MIN	15MIN	30MIN	1HR	2HR	5HR	10HR	20HR
9.60V	150.8	111.0	86.54	52.74	29.25	17.49	8.42	4.77	2.54
10.0V	146.4	105.6	84.76	51.83	29.12	17.36	8.37	4.73	2.50
10.2V	142.1	101.9	83.43	50.87	28.85	17.23	8.33	4.68	2.45
10.5V	127.6	94.03	79.44	50.48	28.58	17.10	8.23	4.64	2.41
10.8V	115.2	85.74	73.23	49.62	27.90	16.79	8.08	4.59	2.36

Constant Power Discharge Characteristics: W/Cell(25°C)

F.V/Time	5MIN	10MIN	15MIN	30MIN	1HR	2HR	5HR	10HR	20HR
9.60V	1591	1182	943.4	591.8	338.0	206.2	100.5	57.03	30.53
10.0V	1559	1146	928.3	584.5	337.2	205.1	100.2	56.67	30.00
10.2V	1542	1116	917.8	580.4	334.6	203.8	99.9	56.17	29.45
10.5V	1403	1039	875.5	576.4	331.6	202.4	98.71	55.62	28.89
10.8V	1278	957.8	809.2	567.1	325.5	199.8	96.93	55.07	28.34

All mentioned values are average values.

Charge Characteristic Curve For Cycle Use(IUI)

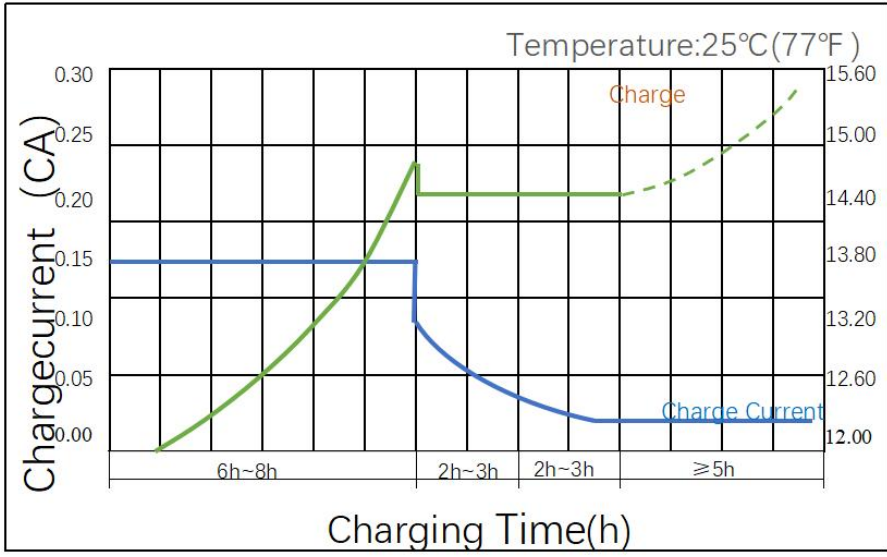

Cycle Life in Relation to Depth of Discharge

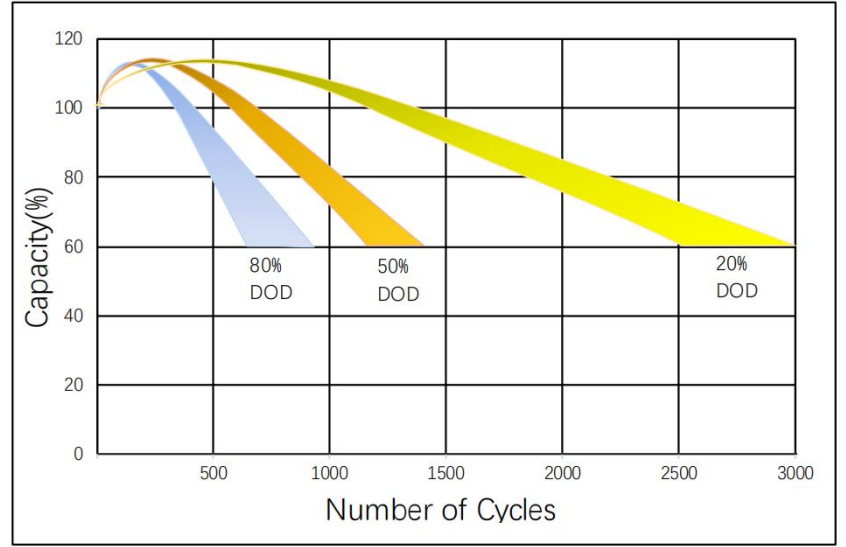

Storage Characteristics

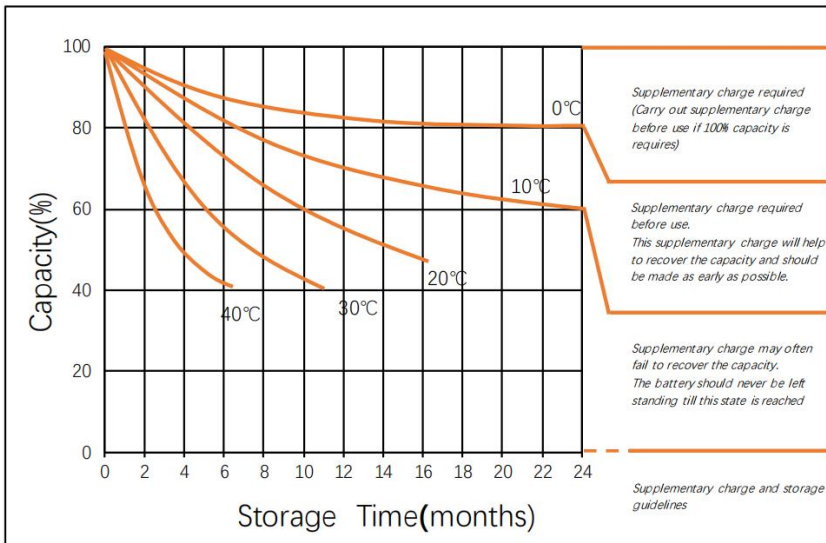

Discharge Characteristics Curve

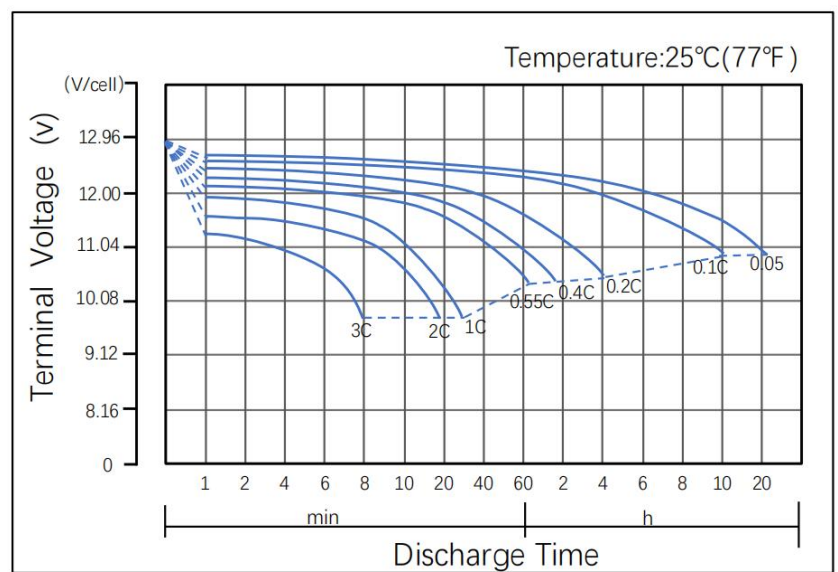

Relationship Between Charging Voltage and Temperature

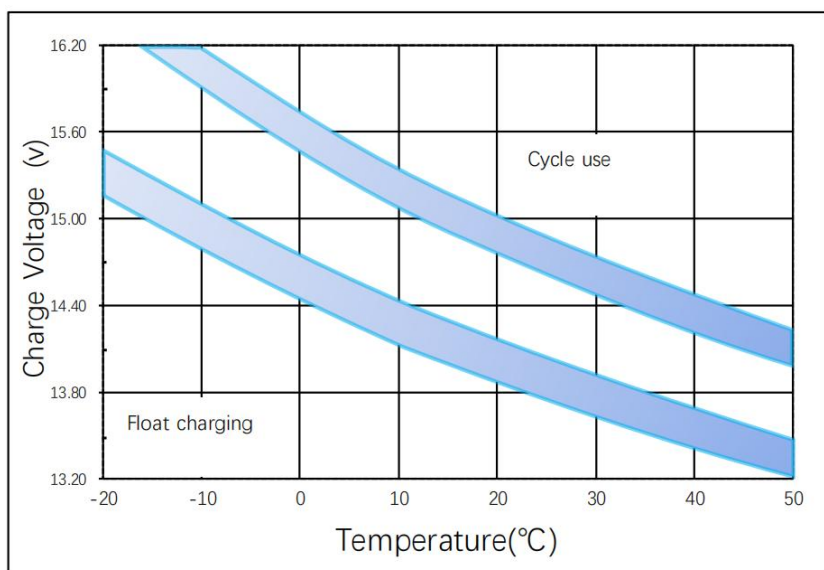

Temperature Effects on Capacity

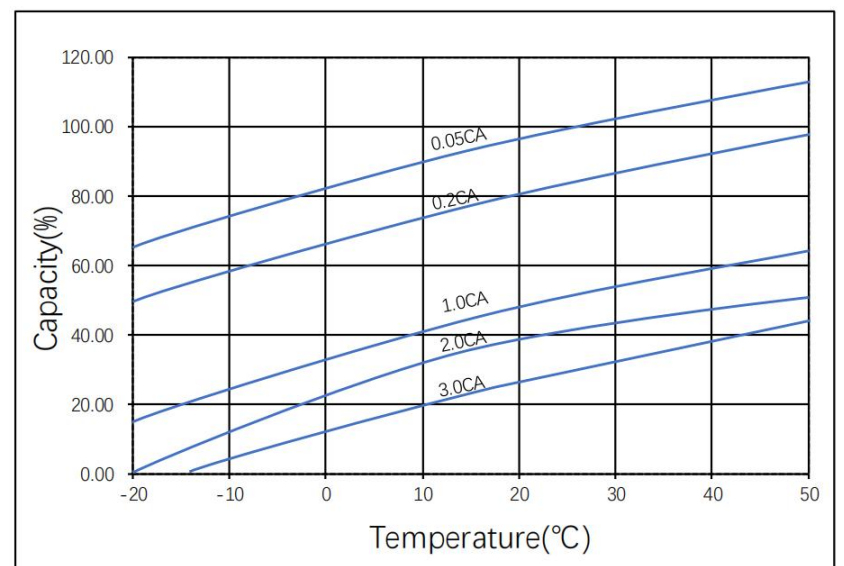

Maintenance & Cautions

- ※ Every month, recommend inspection every battery voltage;
- ※ Every three months, recommend equalization charge once;
Equalization charge method:
Discharge: 100% rate capacity discharge;
Charge: Max. Current 0.3CA, constant voltage 2.35-2.4V/Cell;
- ※ Effect of temperature on float charge voltage: -3mV/Cell;

CONTACT Us

Add: FL.2, No.12 North Ave.1, Industrial Rd. East, Gusan, Guzhen, Zhongshan, Guangdong, China,
T: +86-760- 8862 5562 | **F:** +86-760-8862 5562
Email: sales@holybattery.com johny5@126.com
Website: www.holybattery.com